



# APULJACK

## ELECTRONICS LTD

DESIGN AND REPAIR SPECIALISTS

## Toilet Reed Switch Sensor Fitting Instructions

Product Code: SEN-APU-001-NE



### 1. Overview

This is a small circuit board incorporating the reed switch that senses the waste tank level. This board has been designed to supersede the original in the Thetford C250 toilet models, with only a flush button and a single waste tank level indicator – described as the “one switch” model. This replaces the Thetford boards with the part number 50569 or 42775. The part number is on a small beige square near the contacts or by a small soldered-on component (resistor).

### 2. Product Features

- Fully waterproof, the PCB is coated to prevent moisture damage and corrosion
- Made from high quality components with reliability as a priority
- Waterproof design of joiner to further increase the reliability
- Easy to fit in two minutes with no tools required
- Dimensions: 30mm x 40mm

### 3. Fitting Instructions

#### Step-By-Step Guide

1. Unclip the old printed circuit board (PCB) from the plastic assembly. Pull the PCB up and it will come out of the assembly. Then disconnect the edge connector from the PCB. (See Fig.1)
2. Unclip the wiring if required and pull the edge connector and wiring as close to the door opening as possible so it is easier to work with.
3. Cut the wire around 20mm from the edge connector to get rid of all potential corroded wire whilst keeping as much of the existing wire as possible.
4. Place one cut wire into each of the openings on the free end of the joiner. Make sure the wires are fully pushed into the middle of the joiner (see Fig.2). There is no need to strip the wires.
5. Once the wires are fully in the middle of the joiner squeeze the blue tab until it closes into place. Be aware you will only have one chance to squeeze the blue tab as once it's locked, it will not come undone. Make sure the tab is fully locked down and flush with the surface (See Fig.3).
6. Run the cables back where they originally came from and slot the new PCB back into the plastic assembly slot (See Fig.4) making sure the wiring is pointing forwards and the wires are coming out the back.

#### Pictures of Assembly/Fitting

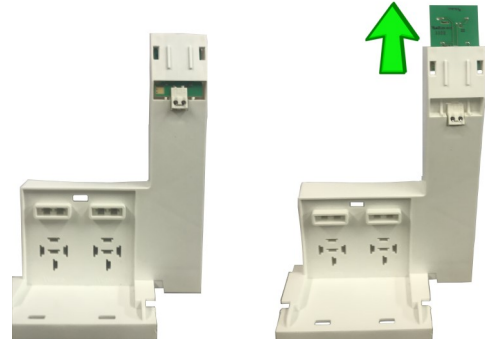

Figure 1

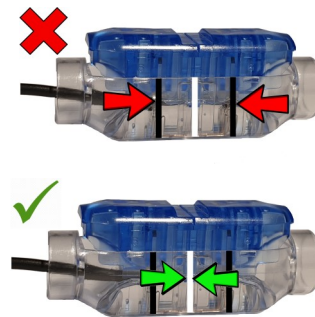

Figure 2

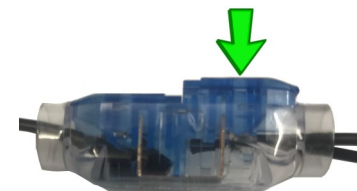

Figure 3

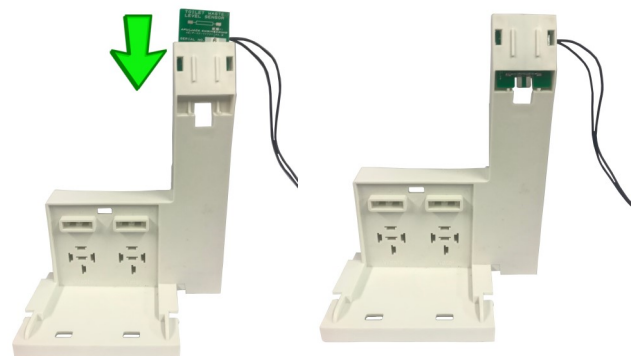

Figure 4

### 4. Warranty

We have extreme confidence that you will never need to buy another toilet reed switch, so you get 5 year warranty on this product!